

1

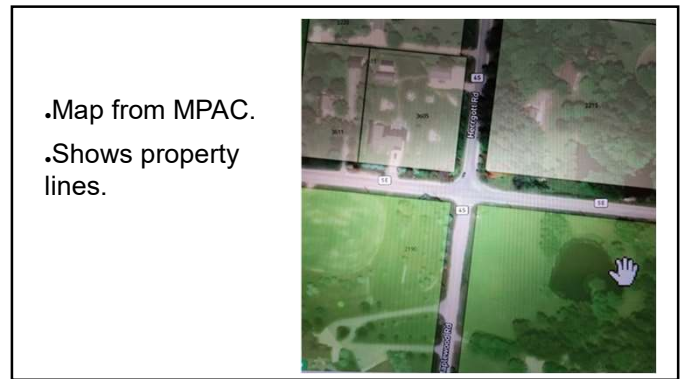

2



3



4

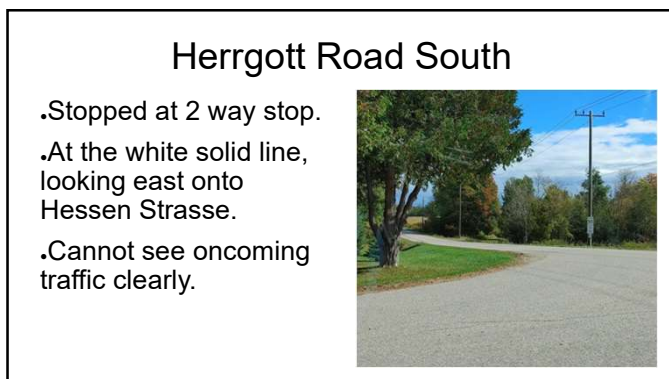

5

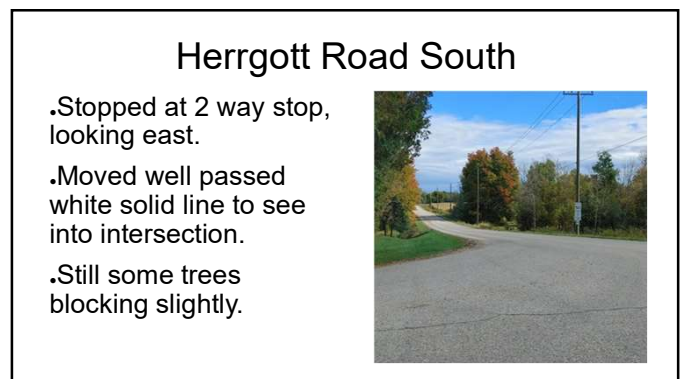

6

Herrgott Road South

- Stopped at 2 way stop.
- At the white solid line, looking west onto Hessen Strasse.
- Cannot see clearly into intersection.



7

Herrgott Road South

- Stopped at 2 way stop, looking west.
- Moved well passed white solid line to see clearly into intersection.



8

Maplewood Road North

- Heading towards intersection from Paradise Lake.
- Approaching 2171 Maplewood Rd.
- Cannot see intersection or stop sign ahead.



9

Maplewood Road North

- Almost at Hessen Strasse.
- At 2171 Maplewood Rd.
- Note small stop sign and new flashing light.
- Difficult to see stop sign, cannot see flashing light.



10

Maplewood Road North

- Stopped at 2 way stop sign.
- At solid white line, looking east onto Hessen Strasse.
- Very difficult to see oncoming traffic.



11

Maplewood Road North

- Stopped at 2 way stop, looking east.
- Moved well passed white solid line.
- Can see clearly into intersection.



12

Maplewood Road North

- .Stopped at 2 way stop.
- .At solid white line, looking west onto Hessen Strasse.
- .Mostly clear other than hydro poles.



13

Maplewood Road North

- .Stopped at 2 way stop, looking west.
- .Moved well passed white solid line.
- .Can see clearly into intersection.



14

Maplewood Rd. North

- .Solid white line at intersection.
- .Drivers must stop behind white line at all intersections.
- .View s/b clear for driver while behind line prior to proceeding.
- .If view not clear drive may creep forward cautiously before proceeding.



15

Hessen Strasse

- .Driving west approaching 2 way stop.
- .Note slight dip in the road just before intersection.



16

Hessen Strasse

- .Driving west approaching 2 way stop.
- .Very treed. Hard to see any cars at intersection.
- .Intersection warning sign posted.



17

Hessen Strasse

- .Driving east.
- .50kms zone.
- .School bus warning sign.
- .Camp entrance ahead.
- .View of road ahead blocked due to hill.



18

Hessen Strasse

- .Driving east.
- .Just over hill by camp entrance.
- .Hidden T intersection on right side.
- .Sign for intersection is for Willow Way road.
- .Starting slow descend down hill.



19

Hessen Strasse

- .Driving east.
- .At T of Willow Way.
- .Mennonite farms on either side with children playing.
- .Slow, long hill continues.
- .No hidden intersection sign.



20

Hessen Strasse

- .Driving east towards intersection.
- .Hidden intersection sign.
- .Bottom of hill, intersection is not visible at all.
- .50kms zone still.



21

Hessen Strasse

- .Driving east.
- .Intersection very close now but cannot see it.
- .Approaching last house before intersection, left side, 3605 Hessen Strasse.



22

Hessen Strasse

- .Driving east.
- .Can finally see intersection – now that you are a few feet away from it.
- .Note: some photos show reflection from dash due to sun and shade outside.



23

Accident

- .Accident on March 23, 2024.
- .One vehicle landed 50 yards onto private property at 2181 Maplewood Rd.
- .The intersection is BEHIND this driver taking photo!
- .2 vehicles involved.
- .Road closed for clean up and investigation.



24

Accident

- Accident on July 20, 2024.
- 2nd accident in 2024 at Hessen Strasse, Herrgott and Maplewood roads.
- Significant damage, airbags went off.



25

Accident

- Accident on September 28, 2024.
- 3rd accident at intersection of Hessen Strasse, Herrgott and Maplewood roads.
- Airbags went off.



26

Accident

- Accident on September 28, 2024.
- 5 days after horrific accident at Hessen Strasse and Greenwood Hill Rd. where 3 young adults died.
- Not even 2 weeks after flashing lights were installed.



27

Accident

- Accident on September 28, 2024.
- 7 days after police ticketed a driver doing 90kms in 50kms zone at Willow Way Rd., next intersection on Hessen Strasse.
- Maplewood resident spoke with police re concern for all these accidents – they said "please do not give up."



28

Stop ahead sign Example

- Stop ahead sign.
- South end of Maplewood Rd.
- Note: taken while walking vs driving.



29

Suggestions to Stop / Eliminate Speed and Accidents

- Implement a 4 way stop at intersection.
- Use bigger stop signs like in town, St. Clements.
- Include large flashing lights above new stop signs.
- Large flashing amber and red lights hanging up at intersection (not above stop signs).
- Stop ahead signs needed.
- Bigger hidden intersection signs needed.
- Trim more vegetation at intersection to improve visibility.
- Community safety zone for 50kms zones on Hessen Strasse, Herrgott and Maplewood roads.
- Rumble strips on Maplewood north and Herrgott south.



30